

2nd Floor

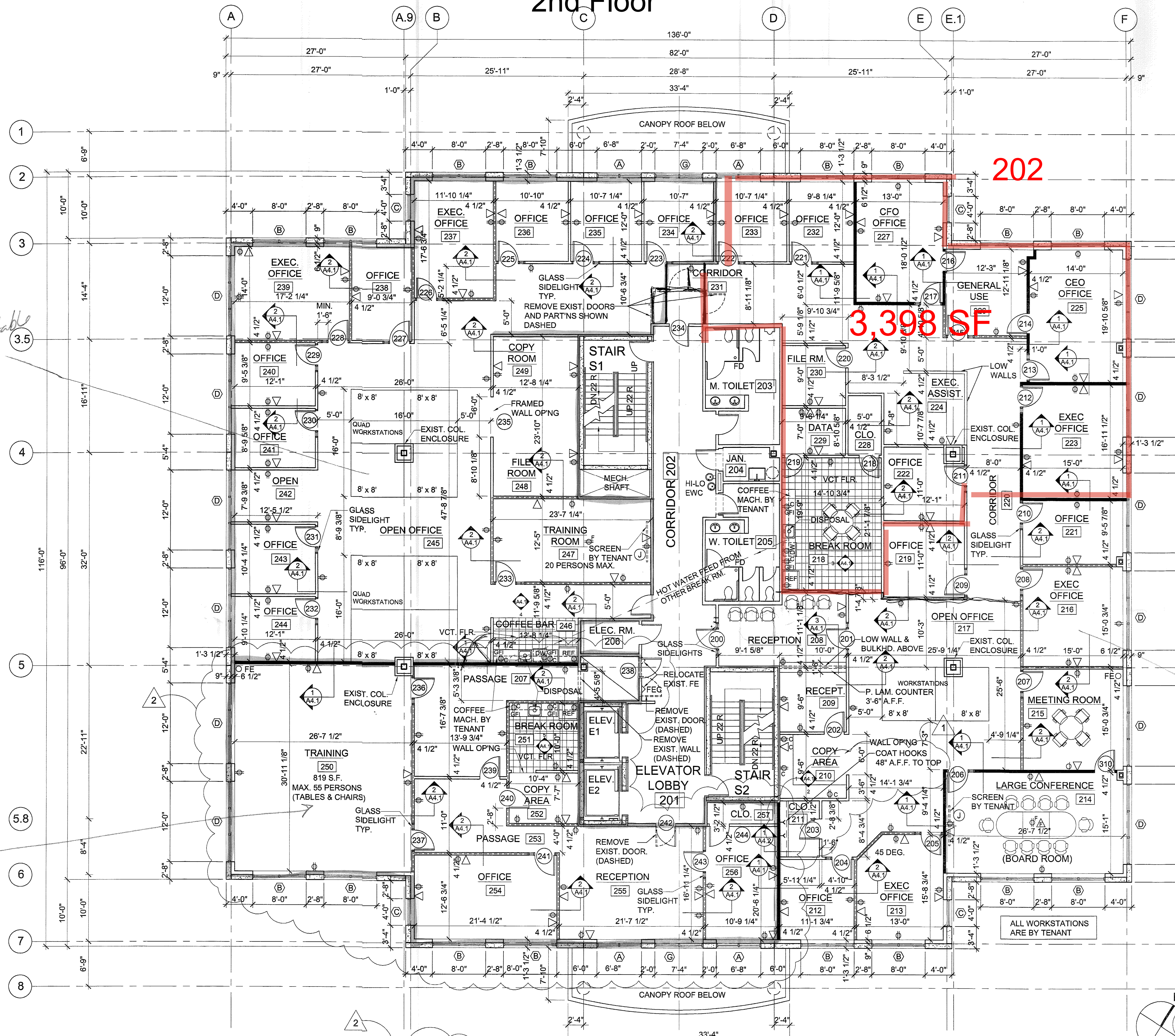

WALL AND PARTITION TYPE LEGEND

- NEW PARTITIONS BUILT UP TO UNDERSIDE OF CEILING
- NEW PARTITIONS BUILT UP TO UNDERSIDE OF CEILING WITH SOUND ATTENUATION FIBERGLASS BATT INSULATION
- NEW WALLS BUILT UP TO UNDERSIDE OF DECK ABOVE WITH SOUND ATTENUATION FIBERGLASS BATT INSULATION
- EXIST. CORE AREA WALLS ARE BUILT UP TO UNDERSIDE OF DECK

1 MEANS OF EGRESS ILLUMINATION OF NOT LESS THAN 90 MINUTE EMERGENCY POWER IS PROVIDED AT THE EXTERIOR OF ALL EXITS PER IBC 2000 SECTION 1003.2.11.2

POWER, VOICE, & DATA LEGEND

- DUPLEX RECEPTACLE
 - QUAD RECEPTACLE
 - DUPLEX RECEPTACLE ABOVE COUNTER
 - GROUND FAULT DUPLEX RECEPTACLE
 - FLOOR QUAD RECEPTACLE W/ FLUSH COVER PLATE
 - VOICE AND DATA PORT IN FLUSH FLOOR BOX
 - VOICE AND DATA PORT
 - JUNCTION BOX
- SEE ELECTRICAL DWGS. FOR POWER, VOICE & DATA TO CUBICLES AND COMPLETE INFORMATION

6955 rentable

4852 rentable

SPACE UP 8-31-16
2895 rentable
13.79

ENVIROSOLUTIONS, INC. NET AREA: 12,469 S.F.
SECOND FLOOR GROSS AREA: 14,696 S.F.

1 SECOND FLOOR PLAN
A2.1 SCALE: 1/8"=1'-0"

SEE FLAME SPREAD & SMOKE DEVELOPMENT RATINGS ON DRAWING A1.1

REVISED PERMIT SUBMITTAL
BLD2006-15125
1 REVISION 1 - PWC COMMENTS - 6/29/06
ARCHITECTURAL REVIEW CHECKLIST DATED 6/22/06
2 REVISION 2 - OWNER REVISIONS
REVISION DATE: 8/25/06

ROBERT KEARNEY ARCHITECT
11703 NEWBRIDGE COURT
RESTON, VIRGINIA, 20191
703-716-5860 FAX: 703-716-1049
E-MAIL: rjkear@erols.com

ASSETT BUILDING
PRINCE WILLIAM COUNTY, VIRGINIA
SECOND FLOOR BUILD OUT FOR:
ENVIROSOLUTIONS, INC.

DATE: 6/8/06
REVISED DATE: 8/25/06
DRAWN BY: JEL
CHECKED BY: RJK

A PROJECT OF MIKE GARCIA & ASSOCIATES
4320 PRINCE WILLIAM PARKWAY, SUITE 113
WOODBRIIDGE, VIRGINIA

SHEET NO.
A2.1